



# GFE-MCPE-C-IP67

## CONVENTIONAL MANUAL CALL POINT OUTDOOR USE - IP67



The GFE-MCPE-C-IP67 is a Conventional Manual Call Point, designed and manufactured to comply with EN54-11, compatible with all GFE Conventional Control panels specially recommended for outdoor use.

The unit is supplied complete with a hinged flap which protects the trigger element from accidental activation and reduces malicious activations as 2 actions are required in order to activate the device. A bi-colour LED flashes Green when the unit is connected to a control panel and is illuminated Red when in Alarm.

The GFE-MCPE-C-IP67 has been designed to deal with today's difficult and harsh environments. It is a unique fire alarm manual call point that mimics the feel of breaking glass whilst offering the user the benefits and safety advantages of a glass-free resettable operating element. Once activated a warning flag drops into view, easily identifying the call point that has been operated. A key can then reset the unit.

The GFE-MCPE-C-IP67 provides an ideal solution for most conventional fire alarm systems. Ideal for all outside applications such as oil rigs, ships, factories as well as wash down areas that are sensitive to broken glass.

### KEY FEATURE

- EN54-11 certified
- Easy installation and maintenance
- Resettable with easy access key
- "Plug & Play" installation concept



© 240125

Global Fire Equipment SA

Sítio da Barracha, Parque Industrial Municipal Caixa Postal 610-A, 8150-017 São Brás de Alportel, Portugal

Telephone: (00351) 289 896 560 / Email: info@globalfire-equipment.com / Web: www.globalfire-equipment.com



GSS GROUP

## TECHNICAL SPECIFICATIONS

OPERATION VOLTAGE	10V to 30V DC
CURRENT - QUIESCENT	200 uA
CURRENT - ALARM	50 mA @ 24V DC nominal - Alarm Resistance 470 Ohms max.
RATING ( SWITCH ONLY )	3A, 125V AC / 10mA, 12V DC
OPERATION TEMPERATURE	-10°C to +55°C
STORAGE TEMPERATURE	-30°C to +60°C
PROTECTION	IP67 - Type A - Outdoor Use
CABLE SIZE	0.5-1.5 mm <sup>2</sup>
MAX. HUMIDITY	95% RH Non-Condensing @ 40°C
COLOUR	Red, Blue, White and Yellow
CASE MATERIAL	ABS & Clear/ PC - Flame Retardant 94 V0
DIMENSIONS	111.9 (H) x 111.9 (W) x 81.3 (D) mm
WEIGHT	262 g includes back box and fixings
COMPATIBILITY	All GFE addressable systems
INSTALATION	Wall mounting

*For EN54-13 compliance, please check the control panel manual specifications.*

## ORDER CODE

**GFE-MCPE-C-IP67**

CONVENTIONAL MANUAL CALL POINT, IP67 - OUTDOOR USE

1328-CPR-0373  
0395-CPR-UKCA-00199



© 240125

Global Fire Equipment SA

Sítio da Barracha, Parque Industrial Municipal Caixa Postal 610-A, 8150-017 São Brás de Alportel, Portugal

Telephone: (00351) 289 896 560 / Email: info@globalfire-equipment.com / Web: www.globalfire-equipment.com



**GSS GROUP**

## DIMENSIONS

Exploded View

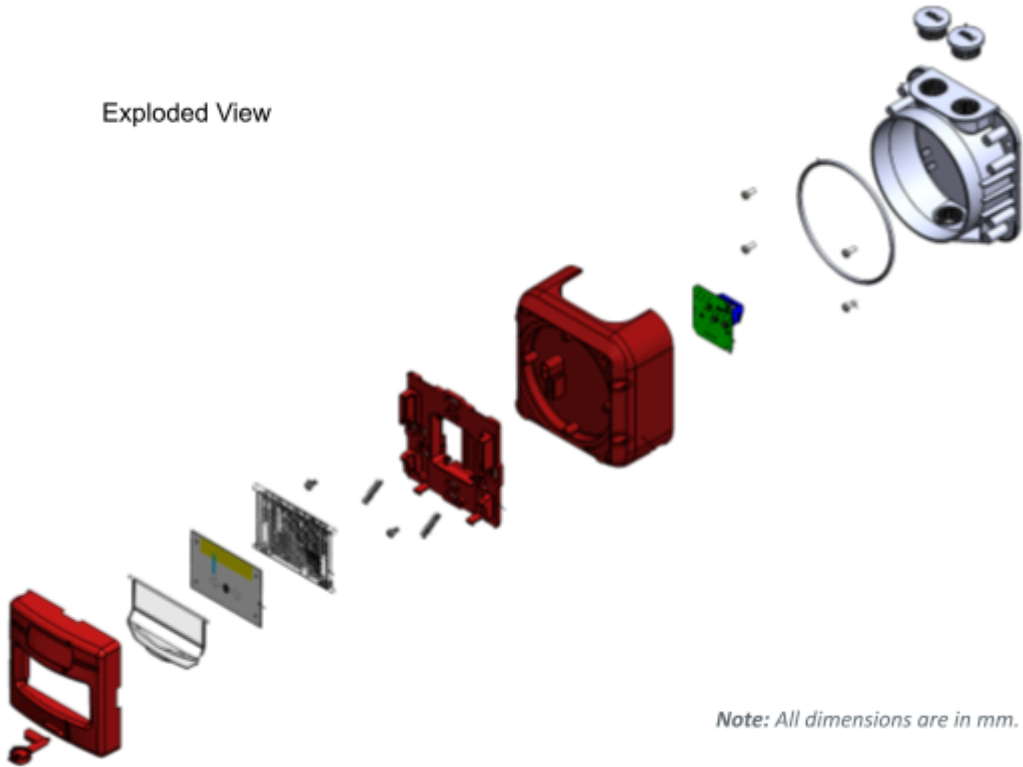

*Note: All dimensions are in mm.*

Front View



Side View

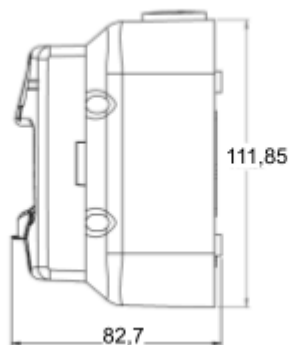

Bottom View

